



MOTOROLA
Semiconductor Products Sector

MECHANICAL OUTLINES
DICTIONARY

98ASB42809B

PAGE 872

COPYRIGHT 1997 MOTOROLA INC ALL RIGHTS RESERVED

DO NOT SCALE THIS DRAWING

ISSUE E

DATE

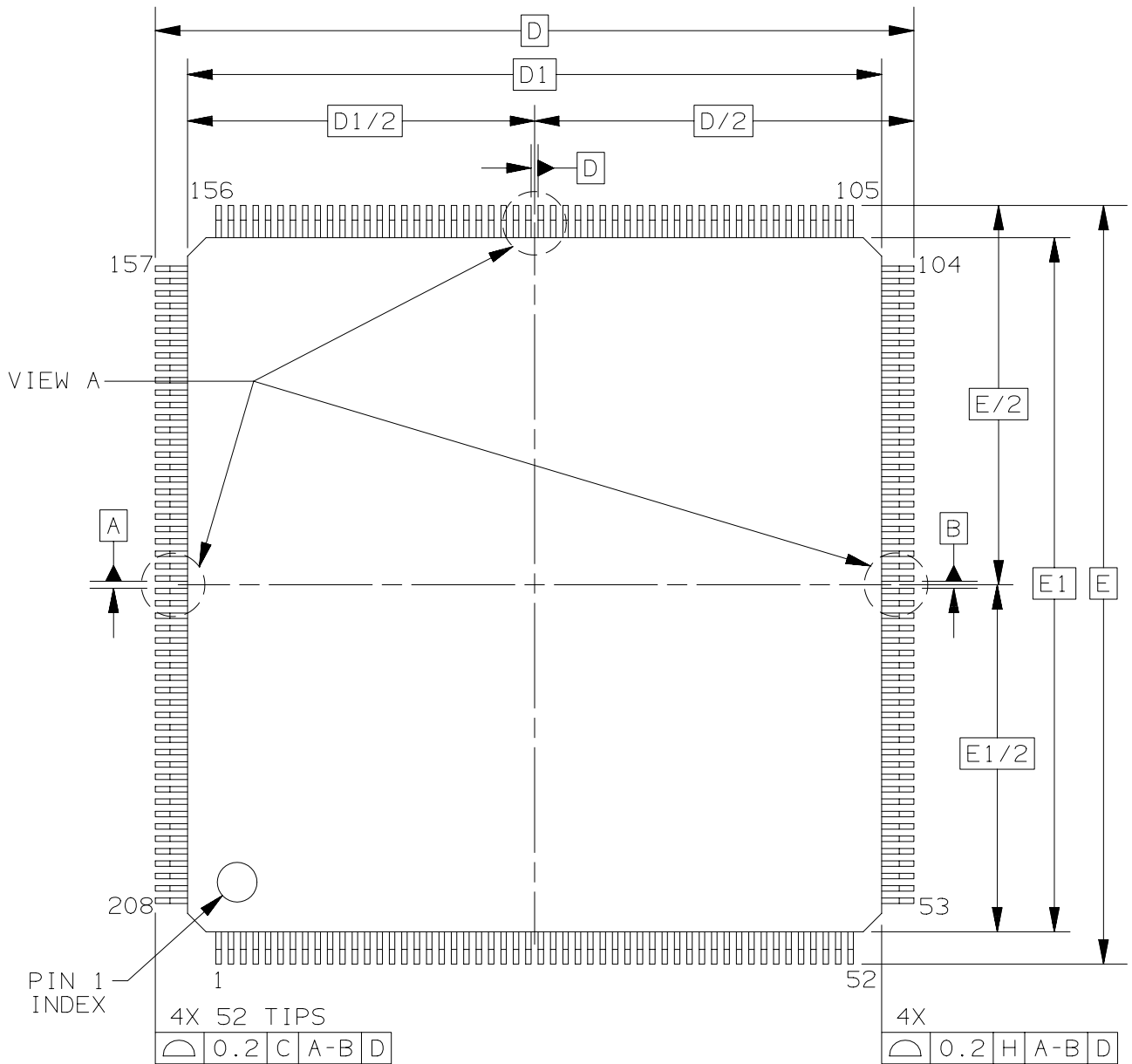

CASE NO.	872-02
STANDARD	MOTOROLA
REFERENCE	
TITLE	208 LD FQFP (28 X 28)

204X e

0.1 C

SEATING PLANE

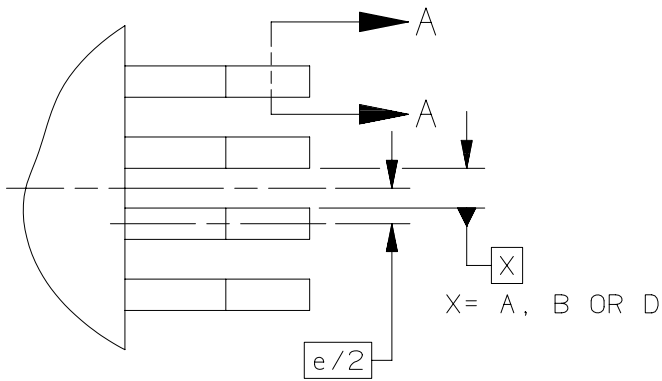

VIEW A
3 PLACES

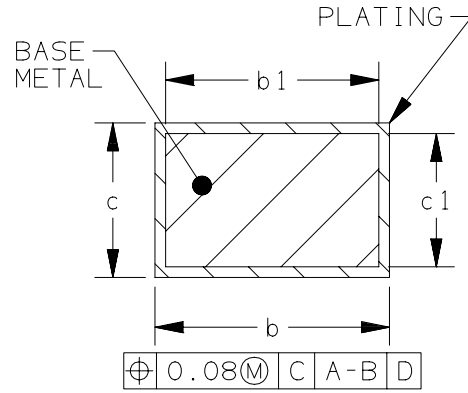

SECTION A-A
160 PLACES
ROTATED 90° CW

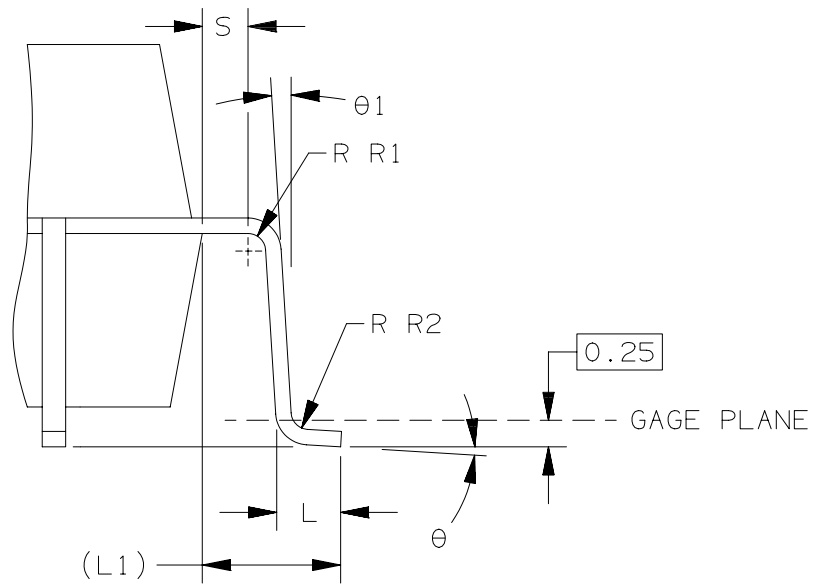

VIEW B

CASE NO.	872-02
STANDARD	MOTOROLA
REFERENCE	
TITLE	208 LD FQFP (28 X 28)



NOTES

1. DIMENSIONS AND TOLERANCING PER ASME Y14.5M-1994.
2. DIMENSIONS IN MILLIMETERS.
3. DATUM PLANE H IS COINCIDENT WITH THE BOTTOM OF THE LEAD WHERE THE LEAD EXITS THE PLASTIC BODY AT THE BOTTOM OF THE PARTING LINE.
4. DATUMS A, B AND D TO BE DETERMINED AT DATUM PLANE H.
5. DIMENSIONS D AND E TO BE DETERMINED AT SEATING PLANE DATUM C.
6. DIMENSIONS D1 AND E1 DO NOT INCLUDE MOLD PROTRUSION. ALLOWABLE PROTRUSION IS 0.25 PER SIDE. DIMENSIONS D1 AND E1 INCLUDE MOLD MISMATCH AND ARE DETERMINED AT DATUM PLANE H.
7. DIMENSION b DOES NOT INCLUDE DAMBAR PROTRUSION. ALLOWABLE DAMBAR PROTRUSION SHALL NOT CAUSE THE LEAD WIDTH TO EXCEED 0.35.

DIM	MILLIMETERS		INCHES		DIM	MILLIMETERS		INCHES	
	MIN	MAX	MIN	MAX		MIN	MAX	MIN	MAX
A	---	4.10							
A1	0.25	0.50							
A2	3.20	3.60							
b	0.17	0.27							
b1	0.17	0.23							
c	0.09	0.20							
c1	0.09	0.16							
D	30.60	BSC							
D1	28.00	BSC							
e	0.50	BSC							
E	30.60	BSC							
E1	28.00	BSC							
L	0.45	0.75							
L1	1.30	REF							
R1	0.08	---							
R2	0.08	0.25							
S	0.20	---							
θ	0°	8°							
θ1	0°	---							
θ2	5°	16°							
CASE NO.		872-02							
STANDARD		MOTOROLA							
REFERENCE									
TITLE		208 LD FQFP (28 X 28)							
									SHEET 3 OF 3